

OPTION 1 – COMPREHENSIVE RENOVATION AND ADDITION
COST RANGE \$39 MIL - \$41 MIL

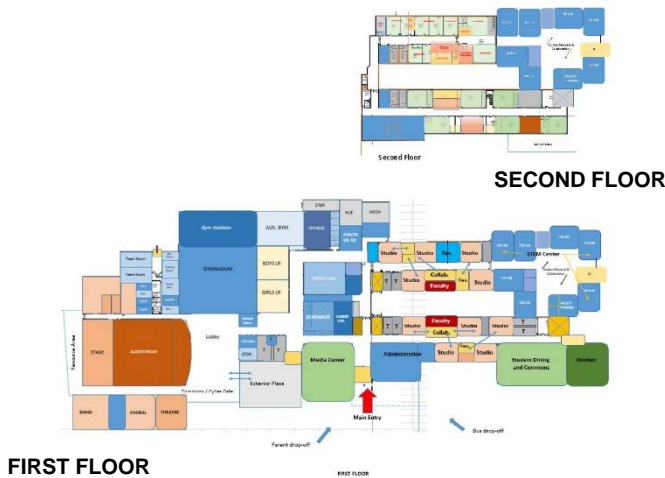

- **PROS**
 - CONNECTS CLASSROOMS WINGS
 - CREATES NEW ART CLASSROOMS
 - CREATES NEW PHYSICAL EDUCATION SPACE
 - INCREASES LOBBY AREA
 - CREATES NEW CAFETERIA/FOYER AREA
 - REPLACES EXISTING MECHANICAL, ELECTRICAL AND PLUMBING SYSTEMS
 - INCREASES SAFETY OF BUS DROP-OFF
- **CONS**
 - DOES **NOT** TRANSFORM SCHOOL FROM TRADITIONAL TO 21ST CENTURY LEARNING SCHOOL
 - PHASED CONSTRUCTION WILL DISRUPT THE EDUCATIONAL PROGRAM

OPTION 2 – COMPREHENSIVE RENOVATION AND ADDITION
COST RANGE \$53 MIL - \$55 MIL



- **PROS**
 - TRANSFORMS CLASSROOMS INTO A 21ST CENTURY LEARNING FACILITY
 - CONNECTS CLASSROOMS WINGS
 - CREATES NEW ART CLASSROOMS
 - CREATES ADDITIONAL PHYSICAL EDUCATION SPACE
 - CREATES ADDITIONAL PERFORMING ARTS SPACE
 - INCREASES LOBBY AREA
 - CREATES NEW CAFETERIA/FOYER AREA
 - REPLACES EXISTING MECHANICAL, ELECTRICAL AND PLUMBING SYSTEMS
 - INCREASES SAFETY OF BUS DROP-OFF
- **CONS**
 - PHASED CONSTRUCTION WILL DISRUPT THE EDUCATIONAL PROGRAM

OPTION 3 – NEW HIGH SCHOOL
COST RANGE \$59 MIL - \$62 MIL

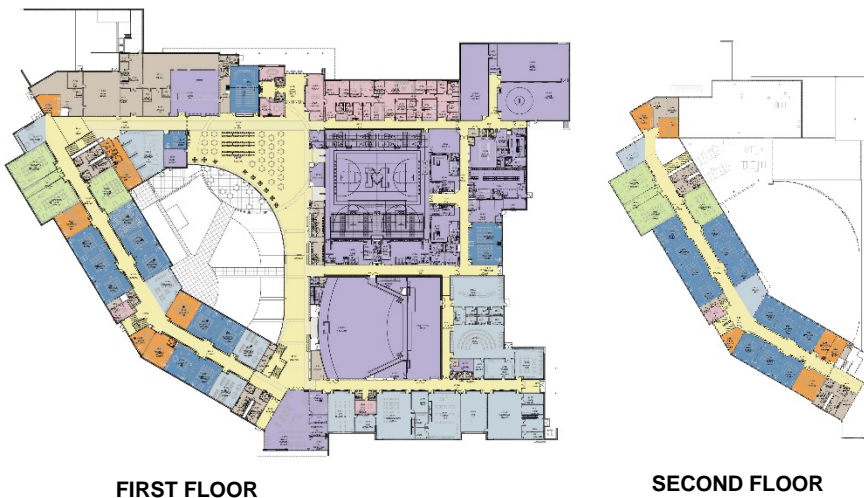

- **PROS**
 - CLASSROOMS ARE DESIGNED AS A 21ST CENTURY LEARNING FACILITY
 - BUILDING IS DESIGNED SPECIFICALLY FOR STAUNTON'S EDUCATIONAL PROGRAM
 - NO DISRUPTION IN THE EDUCATIONAL PROGRAM
 - HEALTHIEST LEARNING ENVIRONMENTS
 - DAYLIGHTING IN ALL EDUCATIONAL SPACES
 - NEW MECHANICAL, ELECTRICAL AND PLUMBING SYSTEMS
 - DESIGNED FOR PASSIVE AND ACTIVE SECURITY SYSTEMS
- **CONS**
 - HIGHEST COST FOR OPTIONS